

# Preliminary Flood Hazard Maps vs. Effective Flood Hazard Maps

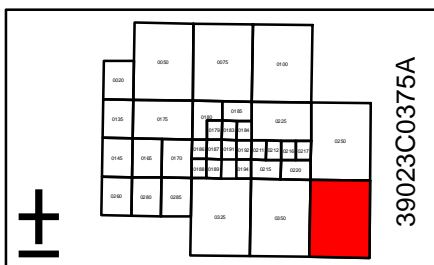
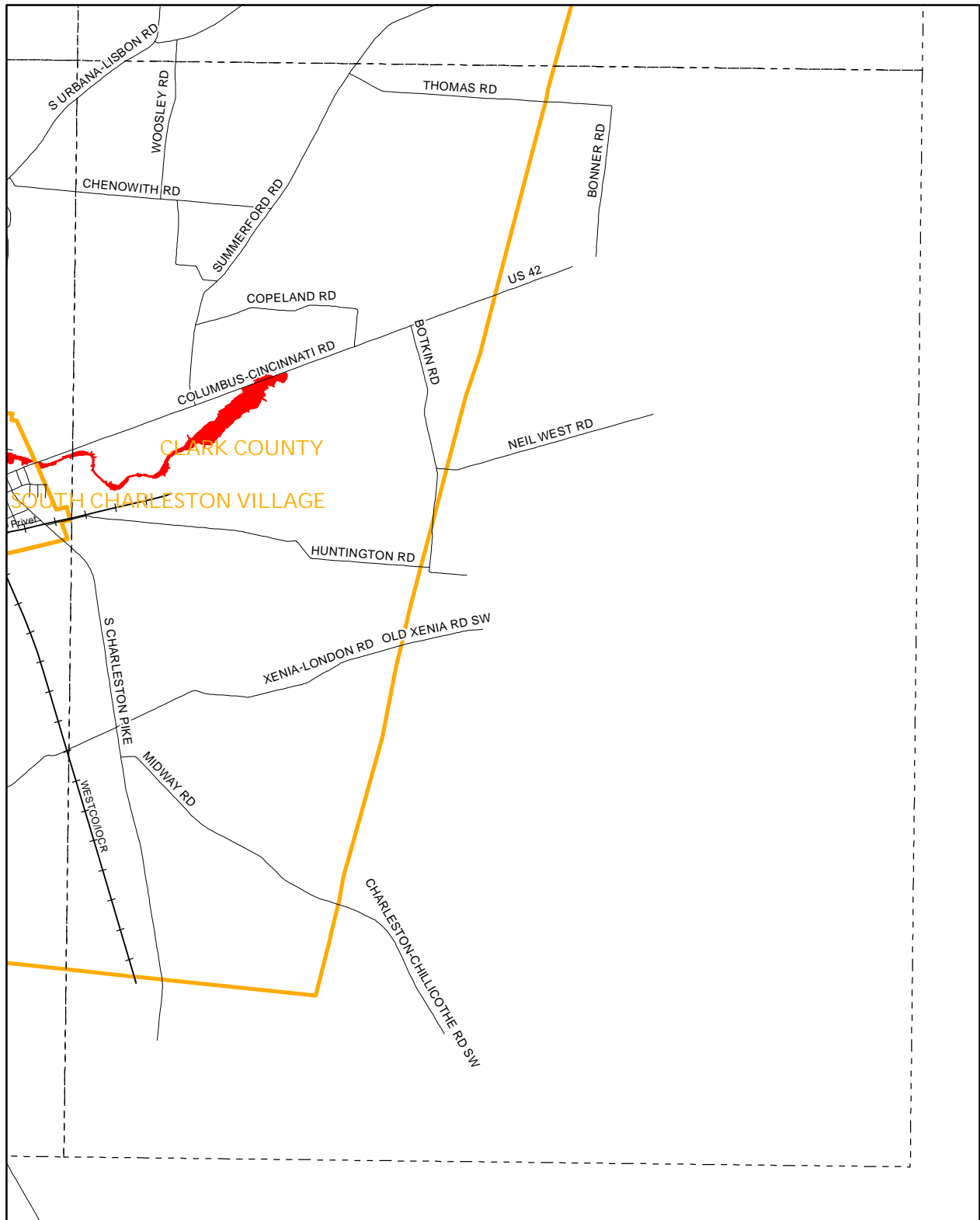

- 7 Incorporated Map Revisions
  - Removed SFHA
  - New SFHA Identified
  - No Change to SFHA
  - Railroad
  - FEMA Map Panel Boundaries
  - Corporation Limits
- ## 1% Annual Chance Floodplain

Panel Scheme follows FEMA 2008 Preliminary DFIRM panels. This map is not to be used for regulatory or insurance purposes. Caution should be taken in areas with map revisions (LOMRs), as these revisions are not incorporated in the current flood maps.